

Data sheet

Commercial Art.No.: Z5.530.1104.0

PCB pin header 8142 S / 11 THR

PCB pin header, 11 poles, pitch: 5 mm, type of packing: carton, color: black, This product can be soldered by reflow and wave soldering



Commercial Art.No.	Z5.530.1104.0
EAN	4049088225697
Order Unit	50

Technical data

general

modular spacing	5 mm
soldering process	THR
packaging	carton
number of poles	11
number of levels	1
marking	no
fastening	none
mating direction towards (circuit) board	180°

technical data

rated current	8 A
overvoltage category I	1000 V
overvoltage category II	250 V
overvoltage category III	200
rated impulse voltage	4 kV

technical data UL/CSA

voltage UL	300 V
current field wiring	15 A
current factory wiring	15 A
voltage CSA	300 V
current CSA	15 A

other

type of insulation material	thermoplastic
-----------------------------	---------------

color	black
height	14.5 mm
length	54.8 mm
depth	2.7 mm
material contact base	CuZn
material contact surface	Sn

classification

ECLASS 11	
ECLASS 8.1	27440402
ETIM 9.0	EC002637
ETIM 8.0	EC002637
ETIM 7.0	EC002637
ETIM 6.0	EC002637
ETIM 5.0	EC002637
ETIM 4.0	EC002637

product compliance

ROHS conformity status	compliant
REACH-SVHC conformity status	compliant

Fits with

Commercial Art.No.:	Article-type description:	Description:
25.600.3153.0	pluggable PCB Terminal 8142 / 11	Pluggable-PCB terminal with screw connection with wire protection, 11 poles, printed version, max. cross section: 2.5 mm ² , pitch: 5 mm, type of packing: carton, color: grey
27.602.1153.0	pluggable PCB Terminal 8142 Z / 11 OB	Pluggable-PCB terminal, 11 poles, with insulating plate, pitch: 5 mm, type of packing: carton, color: grey
25.617.1155.1	pluggable PCB Terminal 8142 ZP/11	Pluggable-PCB terminal with screw connection with rising cage clamp system, 11 poles, printed version, with insulating plate, max. cross section: 2.5 mm ² , pitch: 5 mm, type of packing: carton, color: black
25.617.1155.7	pluggable PCB Terminal 8142 ZP/11	Pluggable-PCB terminal with screw connection with rising cage clamp system, 11 poles, printed version, with insulating plate, max. cross section: 2.5 mm ² , pitch: 5 mm, type of packing: carton, color: green
25.617.4155.1	pluggable PCB Terminal 8142 ZP/11 OB	Pluggable-PCB terminal with screw connection with rising cage clamp system, 11 poles, with insulating plate, max. cross section: 2.5 mm ² , pitch: 5 mm, type of packing: carton, color: black
25.617.4155.7	pluggable PCB Terminal 8142 ZP/11 OB	Pluggable-PCB terminal with screw connection with rising cage clamp system, 11 poles, with insulating plate, max. cross section: 2.5 mm ² , pitch: 5 mm, type of packing: carton, color: green
25.602.3153.0	pluggable PCB Terminal 8142 / 11 OB	Pluggable-PCB terminal with screw connection with wire protection, 11 poles, max. cross section: 2.5 mm ² , pitch: 5 mm, type of packing: carton, color: grey
27.602.4153.0	pluggable PCB Terminal 8142 Z / 11 F2 OB	Pluggable-PCB terminal, 11 poles, with insulating plate, pitch: 5 mm, type of packing: carton, color: grey

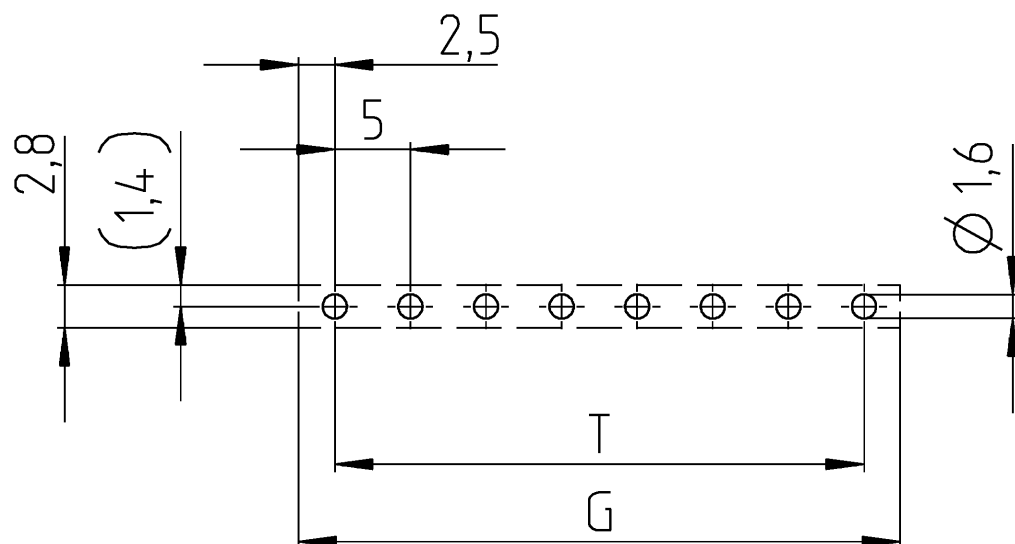

Weitergabe sowie Vervielfältigung dieses Dokuments, Verwertung und Mitteilung seines Inhalts sind verboten, soweit nicht ausdrücklich gestattet. Die Reproduktion, Distribution und Nutzung dieses Dokuments sowie die Kommunikation von its contents to others without express authorization is prohibited.

für folgende Tabellen-Zchnng:
Z5.530.0204.0 8142 S I.. THR

BOHRPLAN

Z5.530.0204.0 11W

23.06.2017 LUS

M 2:1

ⓐ 04.09.2017